

PROPOSED SITE LAYOUT FOR IRAPURAM FACTORY COCHIN, HLL LIFECARE LTD

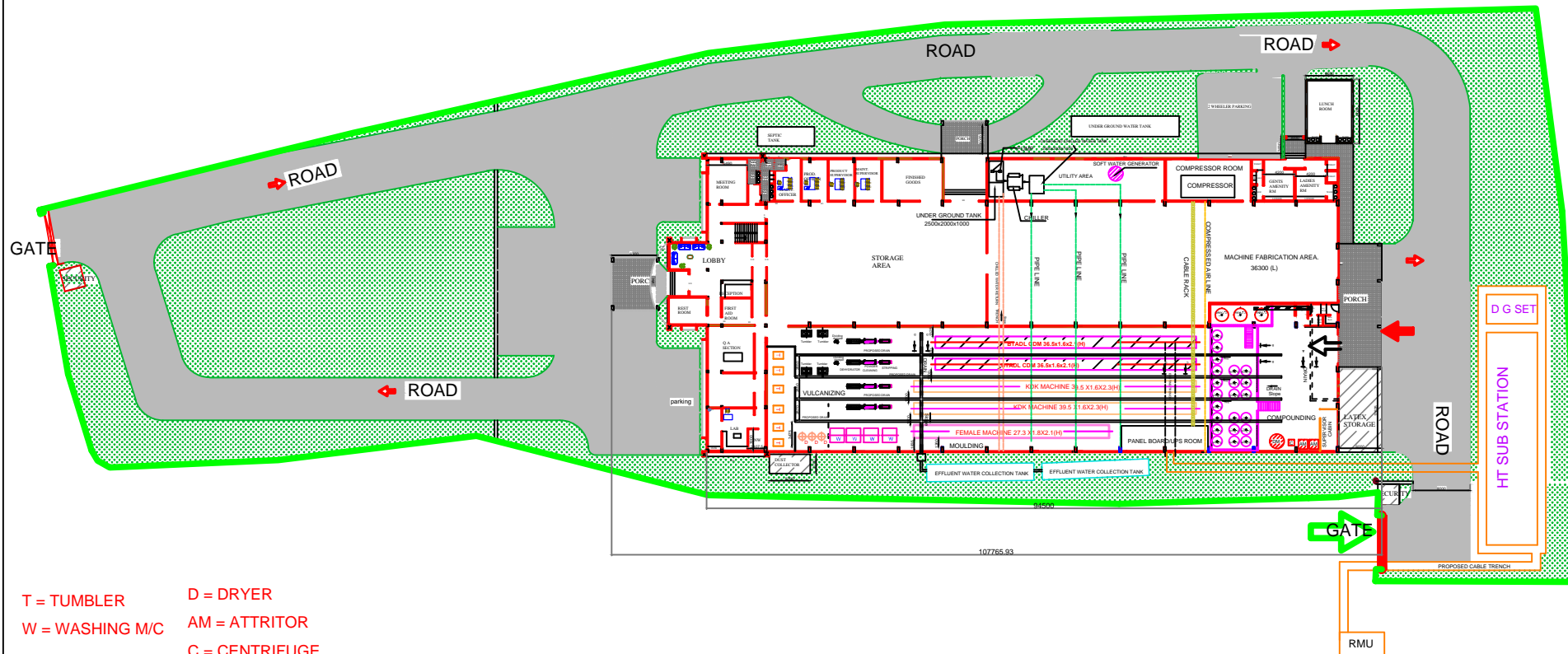
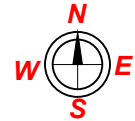

CONSULTANTS:

H L L LIFE CARE LTD.
(A Government of India Enterprise)
INFRASTRUCTURE DEVELOPMENT
DIVISION
VETAMUKKU
THIRUVANANTHAPURAM-6
TEL.: 0471-2365872, 2365873
FAX: 0471-2368144
web: www.hlllifecare.com

ARCHITECTURAL DWG

PROJECT:-

PROPOSED LAYOUT FOR IRAPURAM FACTORY COCHIN, HLL LIFECARE LTD

DRAWING:-

SITE LAYOUT

DRAWN BY:

RVK

SCALE: NTS

ALL DIMENSIONS ARE IN MILLIMETRES. DO NOT SCALE THE DRAWING.

AREA:

CHECKED BY:

-

DATE: 18.07.2013

DISCLAIMER : THESE DRAWINGS ARE THE SOLE PROPERTY OF HLL LIFE CARE LTD. NO CHANGES OR COPIES CAN BE MADE WITHOUT CONSENT.

REVISION

R-1

DRAWING NO.

HLL/IDD/IFC/2013-14/A1

SIGNATURE